



3

3

3

3

4

4

7

10

11



12

13

13

14

15

15

17

17

1.

1.1 General Description

LED

1.2

1.3



1.4

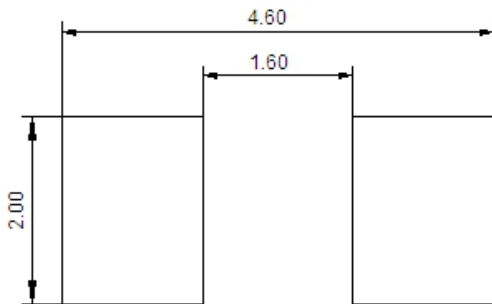
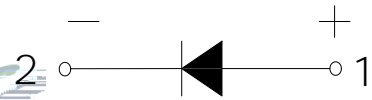
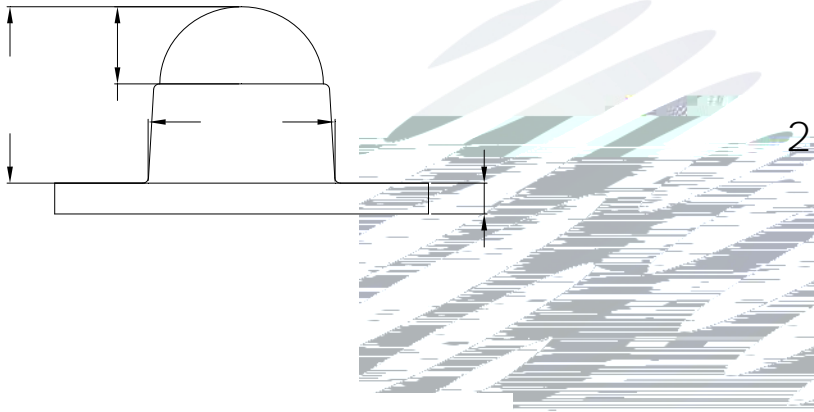
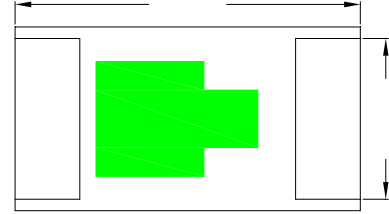
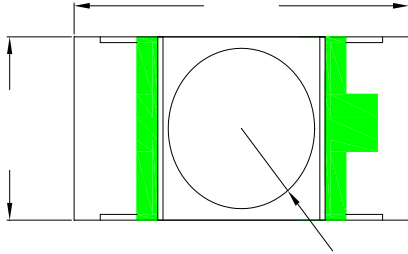

1.

2

±

±0.2

1.5

			G1	2.8	--	2.9	V
			G2	2.9	--	3.0	V
			H1	3.0	--	3.1	V
			H2	3.1	--	3.2	V
			I1	3.2	--	3.3	V
			I2	3.3	--	3.4	V
			J1	3.4	--	3.5	V
			D00	515	--	517.5	nm
			D20	517.5	--	520	nm
			E10	520	--	522.5	nm
			E20	522.5	--	525	nm
			F10	525	--	527.5	nm
			F20	527.5	--	530	nm
			M00	1200	--	1800	mcd
			N00	1800	--	2800	mcd
			O00	2800	--	4300	mcd
			P00	4300	--	6500	mcd
			Q00	6500	--	10000	mcd
							μ

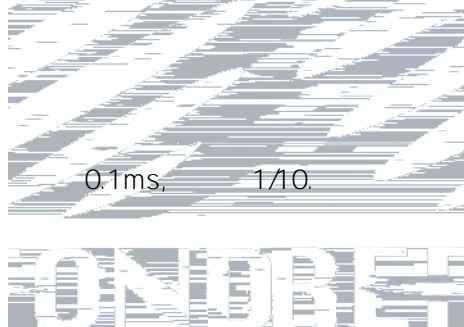

±0.1V.

±2nm.

±10%

. LED

1.

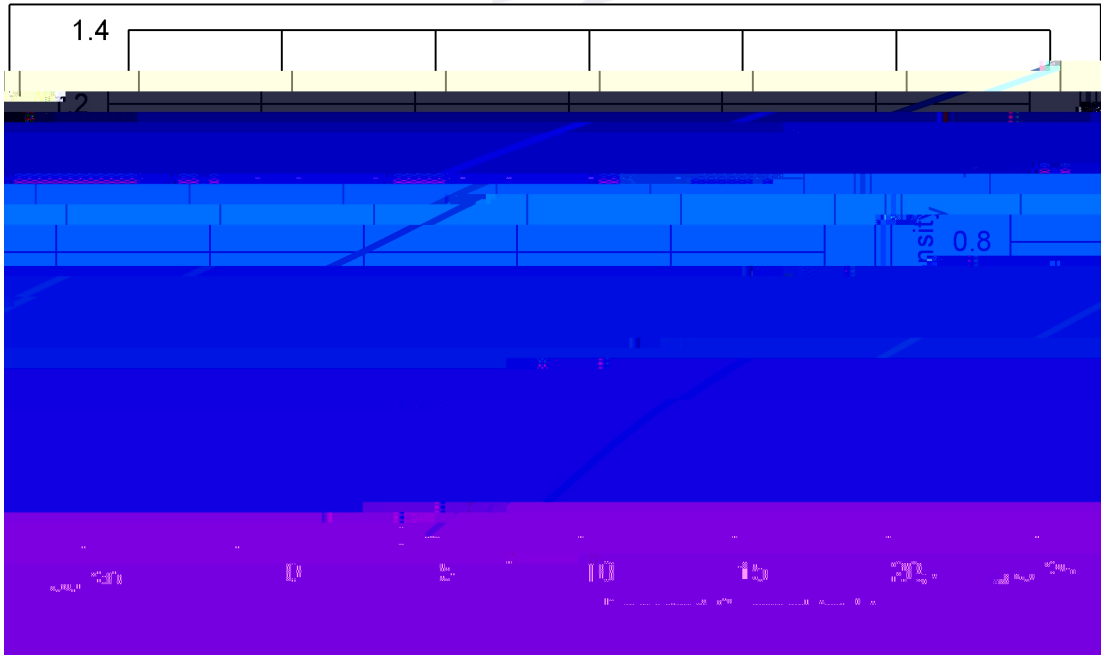
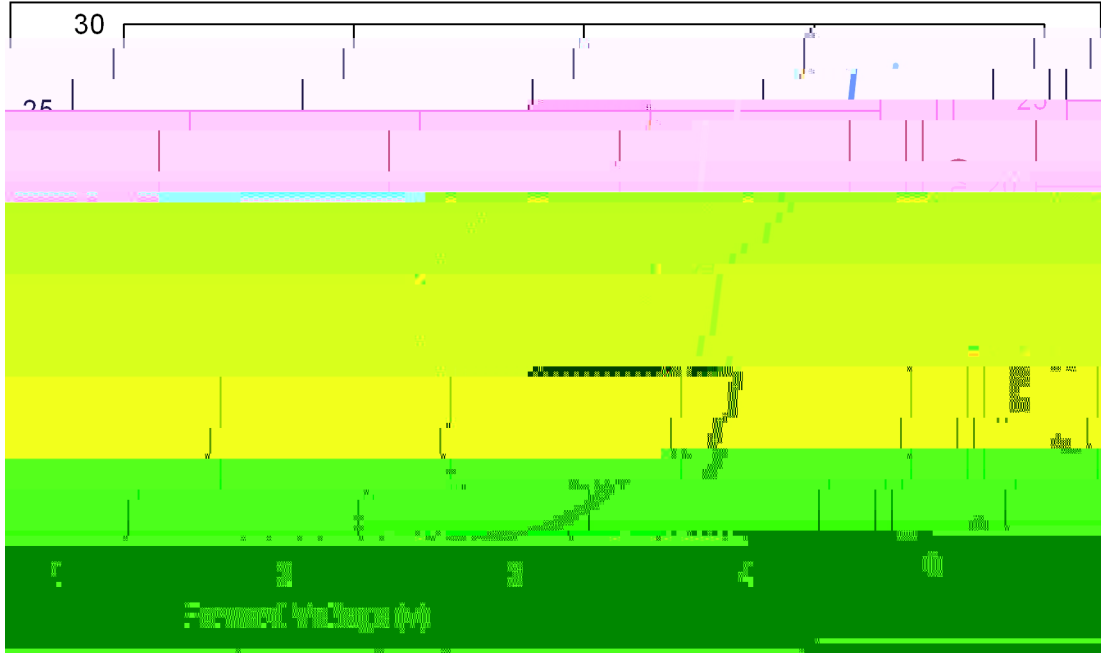

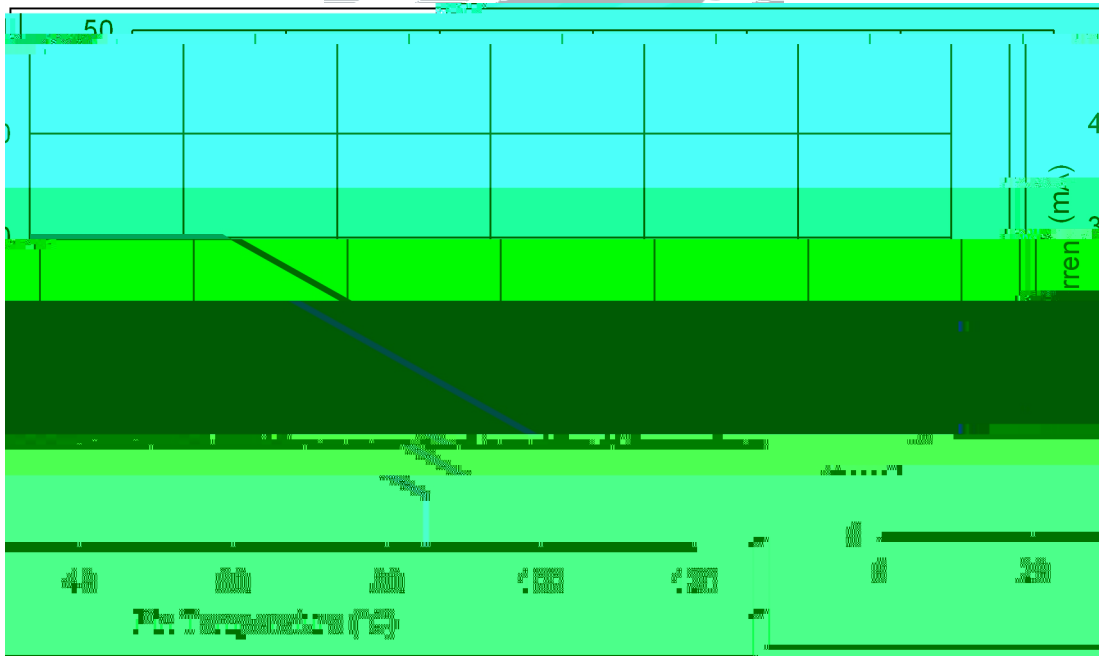
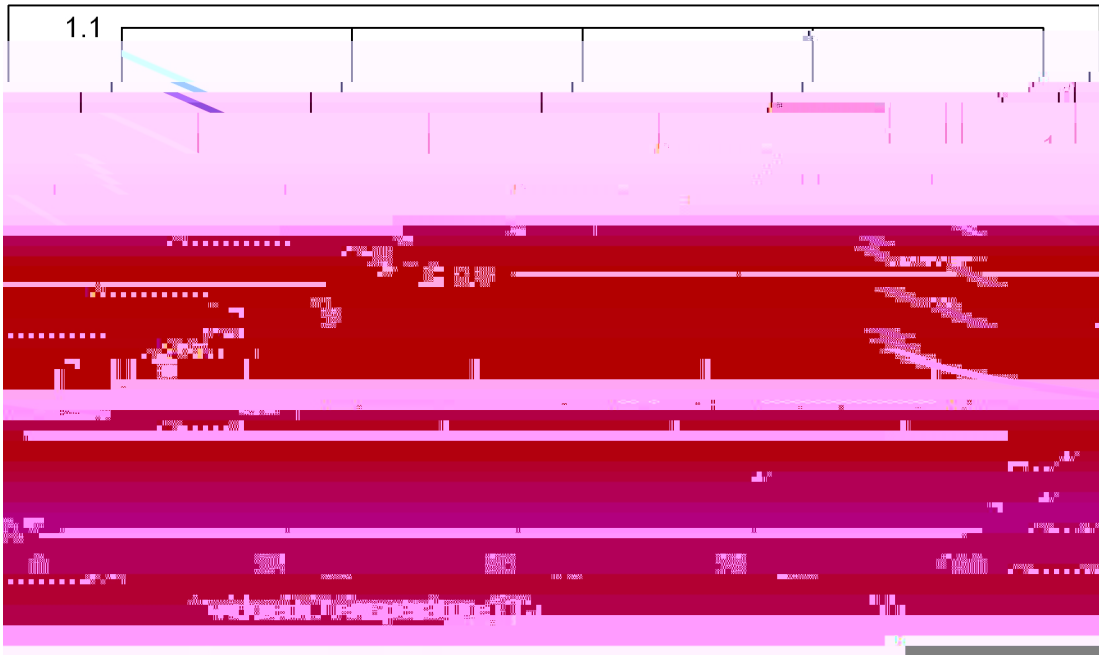

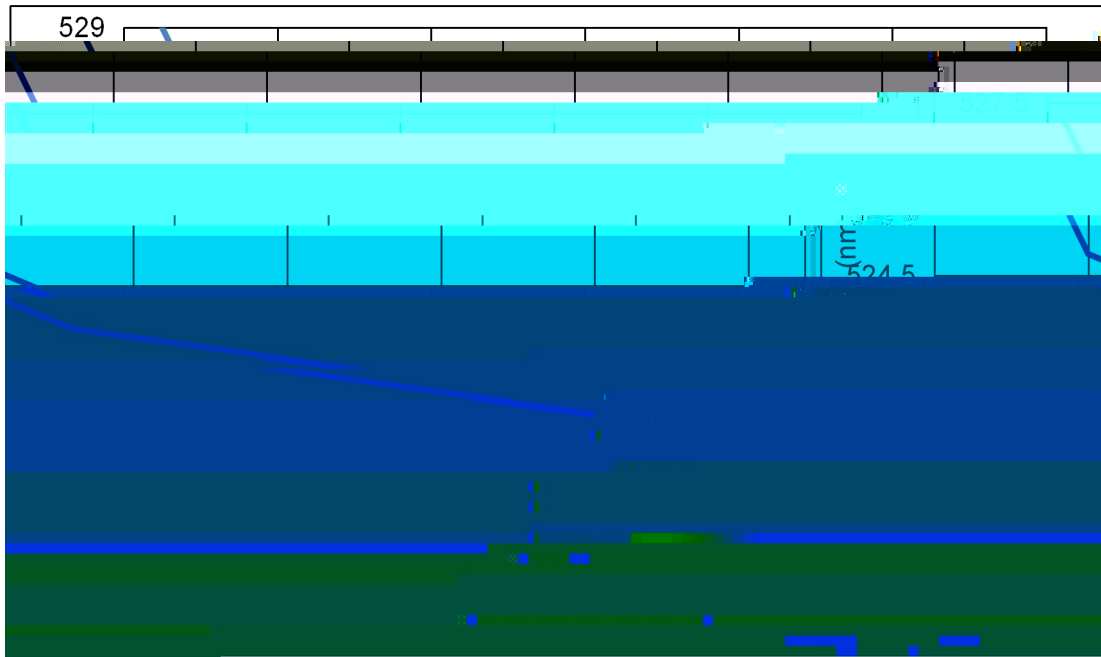
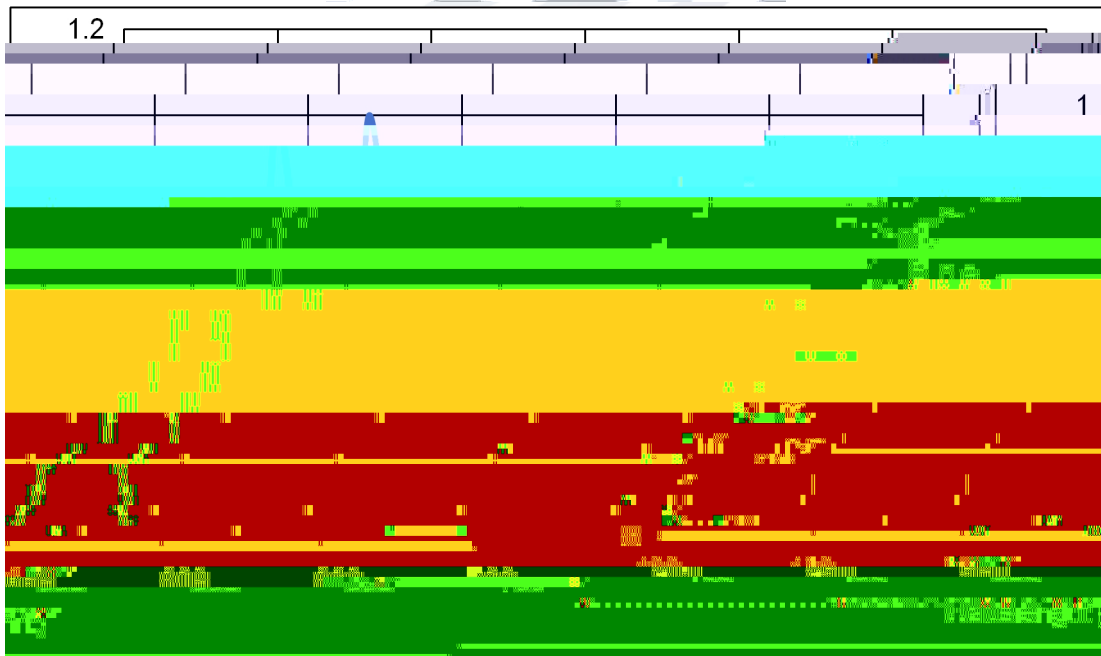
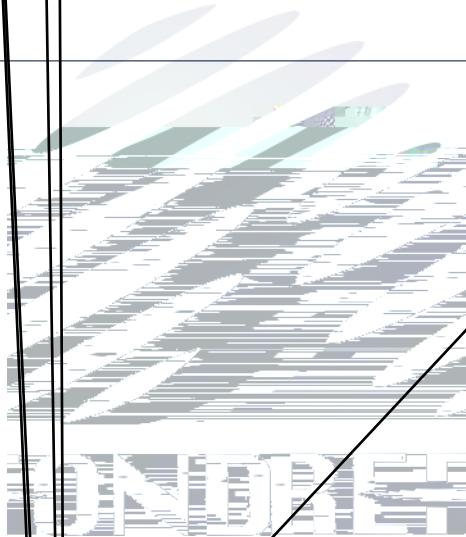
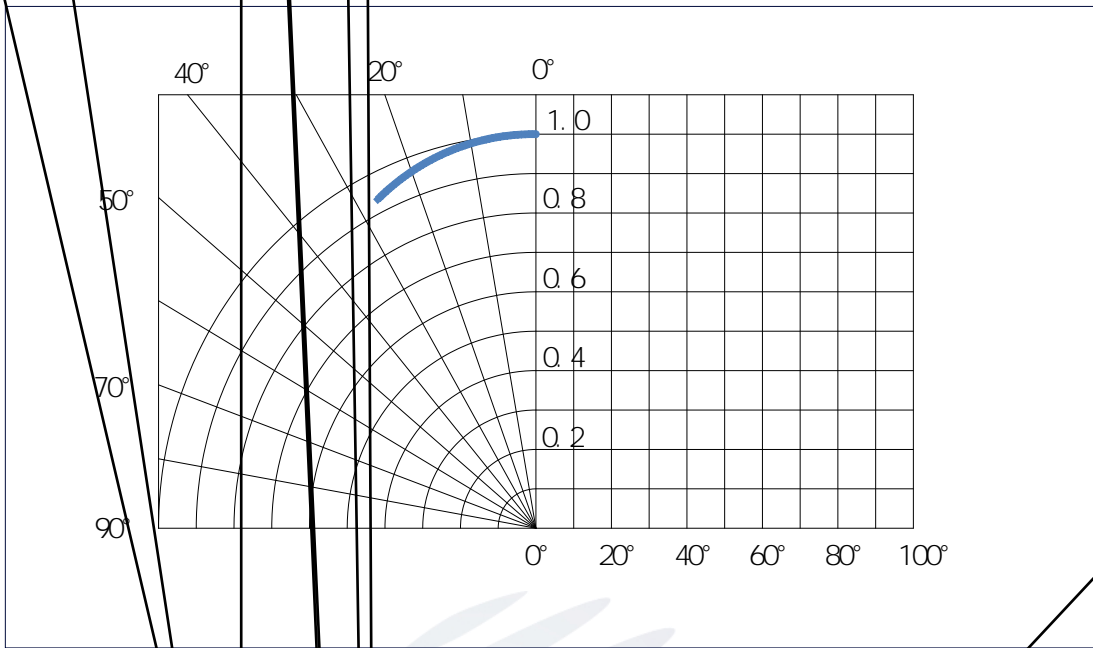
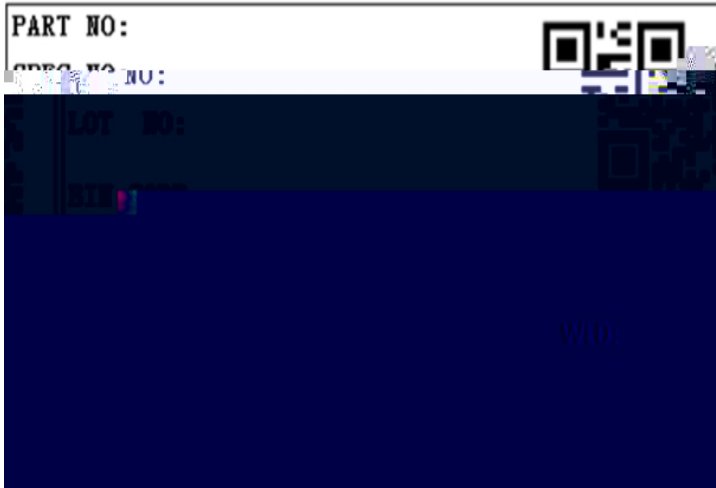

Fig 1-10 Forward Current Vs. Dominate Wavelength (Ta=25°C)











2.2

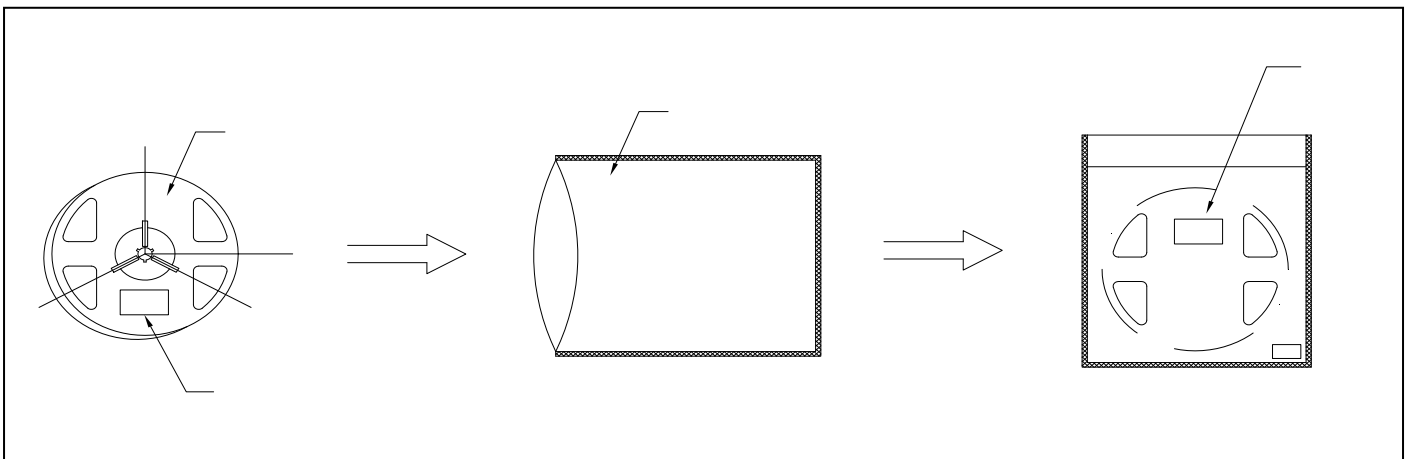

2.5



LED

300

3



LED
LED

LED

PCB

4.

4.1

LED

100PPM.



LED

900PPM

LED

LED

LED

LED

LED

LED



60±5

24

LED



